



# ML5-1/170 NEO



## LED Ø 170 mm Railway front light Combined Head, Marker and Tail light

- Compact solution
- Optical variants for operation in Europe and USA
- Anti-glaring option available
- Easy integration
- Robust and reliable
- SIL2 certified

### Mechanical / Environmental characteristics:

- Operating temperature: - 40°C/+70°C
- Front or rear mounting
- IP66 front and rear
- Shock resistance: IK07
- Glass protective cover
- Cable connection
- UV resistant
- Salt mist resistance : 480 h

### Standards:

- Railway application EN 50155
- EMC EN 50121-3-2
- Shock / Vibrations EN 61373
- Environment EN 60068, EN 60529
- Fire/smoke EN 45545-2, NFPA 130
- Cable EN 50306-4
- REACH, RoHS

### Electrical characteristics:

- Power supply: 24-36 or 72-110 VDC (-30% / +25%)
- Optimized power consumption
- Reduced inrush current
- Long service life: 60 000h
- Light status feedback (potential free contact)

### Options:

- Bearing angle adjustment at ±1.5° on the two axes after mounting
- Anti-glaring fully compliant with table 3
- Defrosting glass

### Optical characteristics:

Characteristics can be adapted for products placed behind customer glass reducing luminous intensity by as much as 35%.

#### Operation in Europe :

- EN 15153-1 / TSI LOC&PAS
- Anti-glaring option available (Table 3)

#### Operation in USA :

- 49 CFR 229.125
- 49 CFR 238.443
- 49 CFR 221.14

Function	Standards	Product features	
	Light intensity (cd)	Light intensity (cd)	Mean consumption (W)+/-20%
Lower full headlight	40 000-70 000	~60 000	~22
Lower dimmed headlight	12 000-16 000	~15 000	~8
Lower full marker light	300-700	~600	~7
Lower dimmed marker light	100-300	~200	~3
Lower tail light	15-100	~80	~3
Upper full marker light	150-350	~300	~4
Upper dimmed marker light	50-150	~100	~2

Function	Standards	Product features	
	Light intensity (cd)	Light intensity (cd)	Mean consumption (W)+/-20%
Full headlight /auxiliary light	> 200 000	~220 000	~36
Dimmed headlight /auxiliary light	-	~100 000	~16
Red marker light	>100 cd and < 1 000	~400	~8



# ML5-1/170 NEO

## Dimensions:

### Front mounting without angle adjustment

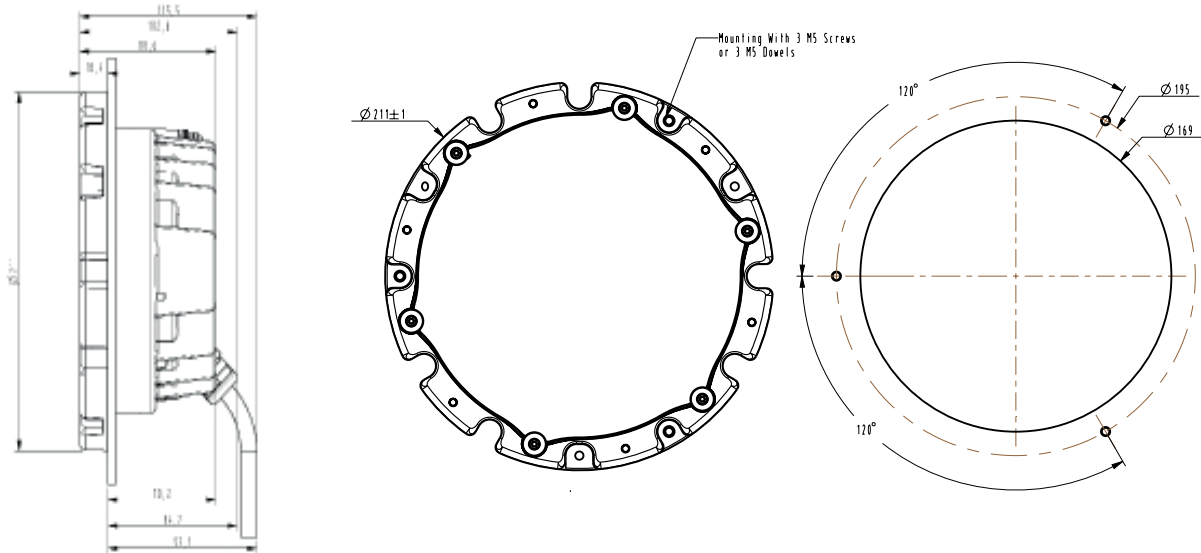

### Rear mounting without angle adjustment

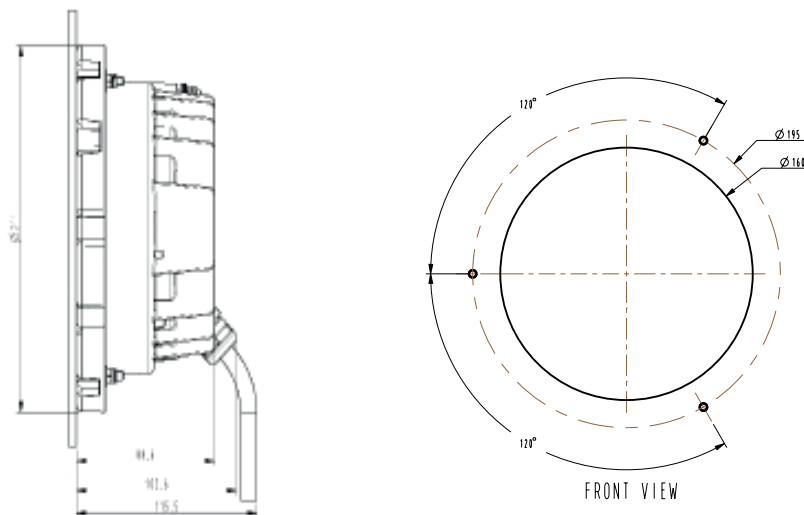



# ML5-1/170 NEO

## Dimensions:

### Front mounting with angle adjustment

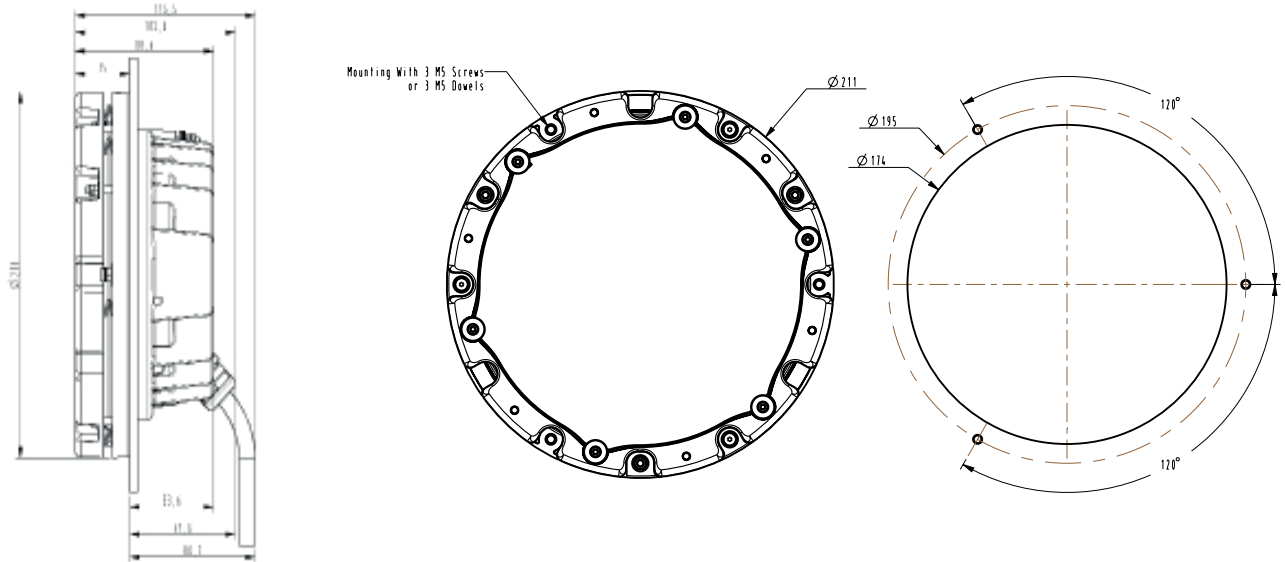

### Rear mounting with angle adjustment

